

# CONTROLLED COPY CENTRAL FILE

2202-2.9  
Revision 0  
05/19/78

G/12  
122

## THREE MILE ISLAND NUCLEAR STATION UNIT 2 EMERGENCY PROCEDURE 2202-2.9 PLANT RESPONSE TO PENETRATION OF THE PROTECTED AREA

Table of Effective Pages

Page	Date	Revision	Page	Date	Revision	Page	Date	Revision
1.0	05/19/78	0	26.0			51.0		
2.0	05/19/78	0	27.0			52.0		
3.0	05/19/78	0	28.0			53.0		
4.0			29.0			54.0		
5.0			30.0			55.0		
6.0			31.0			56.0		
7.0			32.0			57.0		
8.0			33.0			58.0		
9.0			34.0			59.0		
10.0			35.0			60.0		
11.0			36.0			61.0		
12.0			37.0			62.0		
13.0			38.0			63.0		
14.0			39.0			64.0		
15.0			40.0			65.0		
16.0			41.0			66.0		
17.0			42.0			67.0		
18.0			43.0			68.0		
19.0			44.0			69.0		
20.0			45.0			70.0		
21.0			46.0			71.0		
22.0			47.0			72.0		
23.0			48.0			73.0		
24.0			49.0			74.0		
25.0			50.0			75.0		

Unit 1 Staff Recommends Approval

Approval NA Date         
Cognizant Dept. Head

Unit 2 Staff Recommends Approval

Approval NA Date         
Cognizant Dept. Head

Unit 1 PORC Recommends Approval

NA Date         
Chairman of PORC

Unit 2 PORC Recommends Approval

J. F. Hillish Date 5/19/78  
✓ Chairman of PORC

Unit 1 Superintendent Approval

NA Date       

Unit 2 Superintendent Approval

J. F. Hillish Date 5/19/78

Manager Generation Quality Assurance Approval NA Date

THREE MILE ISLAND NUCLEAR STATION  
UNIT 2 EMERGENCY PROCEDURE 2202-2.9  
PLANT RESPONSE TO PENETRATION OF THE PROTECTED AREA

1.0 SYMPTOMS: (One or more of the following).

- 1.1 A penetration (forcible entry) of a protected area barrier defined by (Figure 1) has occurred based on visual, confirmed, observation, and the intruder's failure to halt, as reported by a Site Protection Officer/Sergeant to the Shift Supervisor or Shift Foreman.
- 1.2 Station Security Procedures have been implemented to apprehend the person(s) who penetrated (forced entry) the protected area barrier, and State Police have been notified that the protected area barrier has been penetrated.
- 1.3 Hostile groups or antinuclear demonstrators are present near the facility perimeter and have increased the potential protected area penetration threat level.

2.0 IMMEDIATE ACTION:

2.1 Automatic Action: None.

2.2 Manual Action

- a. If the protected area barrier (Figure 1) has been penetrated and the person(s) accomplishing the penetration is not immediately physically apprehended as confirmed by a Site Protection Officer direct to the Shift Supervisor or Shift Foreman, orally by radio or walkie-talkie, then the Unit shall be immediately shutdown by tripping the reactor and carrying out the Reactor Trip Emergency Procedure (2202-1.1).

CAUTION: If it is clearly determined that the penetrator does not pose a real threat to the safety of the unit, the reactor should not be tripped.

- b. Announce the reactor trip and the reason for the trip over the page and bring the Unit to the hot standby condition and establish stable plant conditions.

3.0 FOLLOWUP ACTIONS:

- 3.1 If the person(s) who have accomplished the penetration are not immediately physically apprehended, the security force with the help of other plant personnel shall ascertain the intruder's probable location and direct personnel to watch that area until the area can be safely entered.
- 3.2 Depending upon the nature and magnitude of the penetration and the resulting potential threat, other protective measures should be considered which may include, but not be limited to the following:
  - a. Locking the Control Room doors and Access Control point doors.
  - b. Close the Auxiliary Building or Fuel Handling Building concrete doors, if open, or station a guard at these locations.
  - c. Muster all station personnel by requesting personnel to call the Unit 2 Control Room.



FIGURE-1

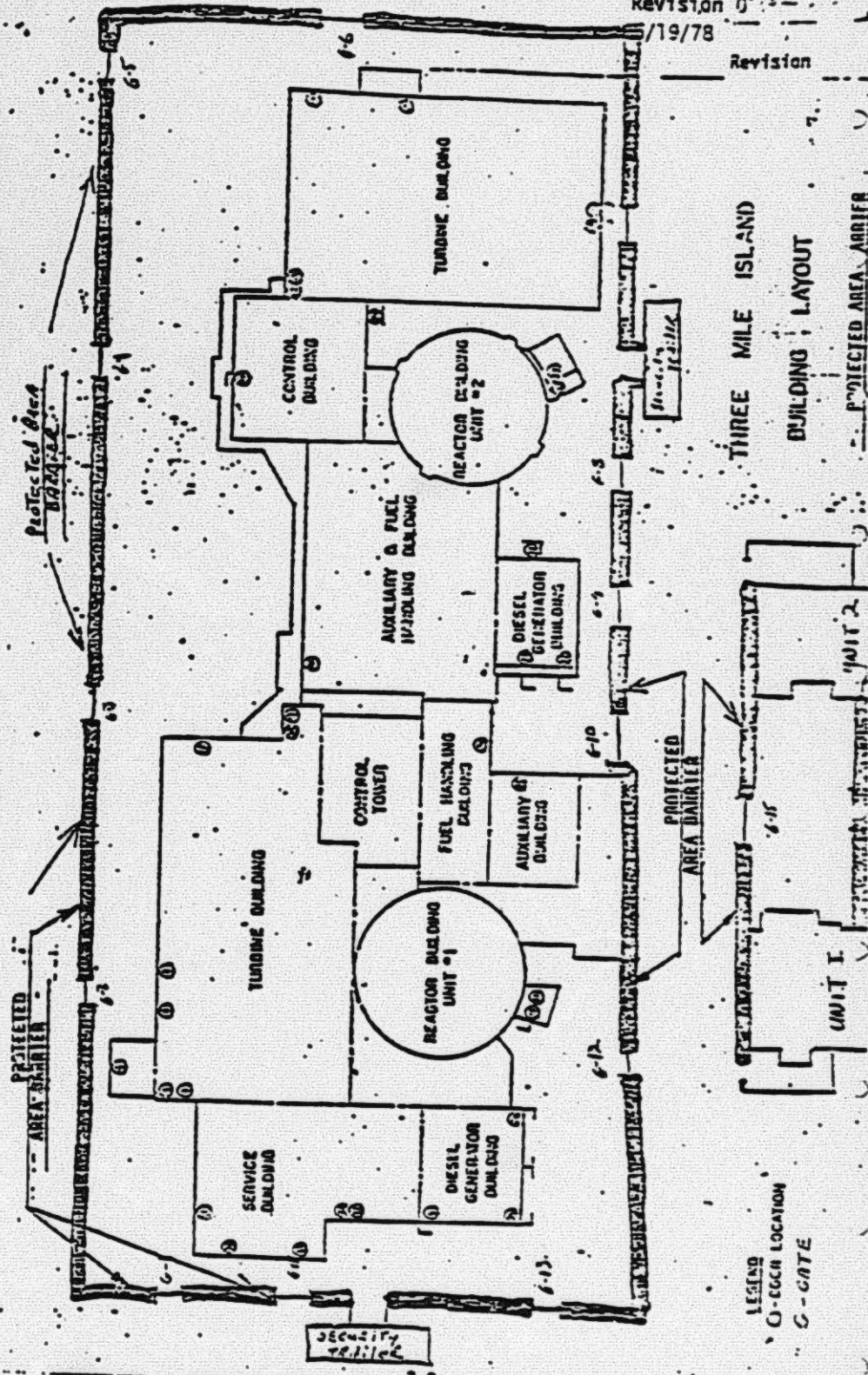

THREE MILE ISLAND

BUILDING LAYOUT

PROTECTED AREA BARRIER

LEGEND  
 O - EACH LOCATION  
 G - GATE